

Service Bulletin

Fuel Systems

Bulletin No.: RS-73

Date: 11/15/80

Revised: _____

Subject: DISTRIBUTOR VALVE ASSEMBLY, PARTS LIST 391806-3 TO -4,
 PARTS LIST 391828-3 TO -4, PARTS LIST 2524178-1 TO -2, AND
 PARTS LIST 2524591-1 TO -2, MODIFICATION OF.

1. PLANNING INFORMATION:

A. EFFECTIVITY:

<u>Model Number</u>	<u>Parts List Number</u>
Distributor Valve Assembly	391806-3
Distributor Valve Assembly	391828-3
Distributor Valve Assembly	2524178-1
Distributor Valve Assembly	2524591-1

B. REASON:

To provide detailed instructions for the modification of the Distributor Valve Assemblies listed above to incorporate the new seat and ball valve assembly.

C. DESCRIPTION:

Replace the existing seat and valve assembly with the new seat and ball valve assembly.

D. COMPLIANCE:

Operating Activities: Information only.

Overhaul Activities: Comply at overhaul.

E. APPROVAL:

F. MANPOWER:

Approximately 0.5 additional man-hours required at overhaul.

G. MATERIAL AVAILABILITY:

<u>Part No.</u>	<u>Qty.</u>	<u>Nomenclature</u>	<u>Availability</u>
364868	1	Nut	Bendix Products Support Centers
364447	1	Washer	Bendix Products Support Centers

1. PLANNING INFORMATION: (Continued)

<u>Part No.</u>	<u>Qty.</u>	<u>Nomenclature</u>	<u>Availability</u>
383442	2	Cup	Bendix Products Support Centers
2521720	1	Diaphragm	Bendix Products Support Centers
or			
2540888			
2525223	1	Valve	Bendix Products Support Centers
2525221	1	Seat	Bendix Products Support Centers

Note: Diaphragm P/N 2521720 is not stocked. Diaphragm P/N 2540888 will become available approximately 4/81. Contact Bendix Products Support Centers upon ordering to confirm part availability.

Until diaphragm P/N 2540888 becomes available, diaphragm 2521720 can be obtained by disassembly of (new) diaphragm assembly P/N 2521721.

H. TOOLING:

Locally manufactured.

I. WEIGHT AND BALANCE:

Not affected.

J. REFERENCES:

None.

K. PUBLICATIONS AFFECTED:

Overhaul Manual and Illustrated Parts List, Distributor Valve Assembly. Bendix Form 15-549A.

2. ACCOMPLISHMENT INSTRUCTIONS:

A. During the course of overhaul of the Parts List Numbers 391806-3, 391828-3, 2524178-1 and 2524591-1, Distributor Valves, proceed as follows: (Refer to figure 4-1 of the affected publication).

- (1) Locally fabricate a puller and remove the part number 367648 seat from the body (26).
- (2) Apply Loctite Hydraulic Sealant sparingly to the OD of the new P/N 2525221 seat.

NOTE: Loctite products are procurable from Loctite Corporation, 705 North Mountain Road, Newington, Connecticut 06111.

- (3) Press the part number 2525221 seat into the cover (26) with an arbor press to the dimension indicated in figure 1 of this directive. Wipe excess sealant from the bushing and cover, with MEK or acetone.

2. ACCOMPLISHMENT INSTRUCTIONS: (Continued)

- (4) Assemble together parts (1 through 6, figure 2) of this directive and tighten nut (1) to a torque value of 5-7 inch-pounds. Retorque to original value after 20 minutes. Retorque only once.
- (5) Reassemble the Distributor Valve Assembly as outlined in the affected publication except discard the spring (23) and valve assembly (24) and install the parts assembled in preceding step (4) in place of diaphragm assembly (20).
- (6) Functionally test the Distributor Valve Assembly as outlined in the affected publication.

B. IDENTIFICATION:

Since these Distributor Valve Assemblies do not incorporate an identification plate, it is permissible to etch the parts list and new issue number on the cover.

Old P/L and Issue No.

New P/L and Issue No.

391806-3
 391828-3
 2524178-1
 2524591-1

391806-4
 391828-4
 2524178-2
 2524591-2

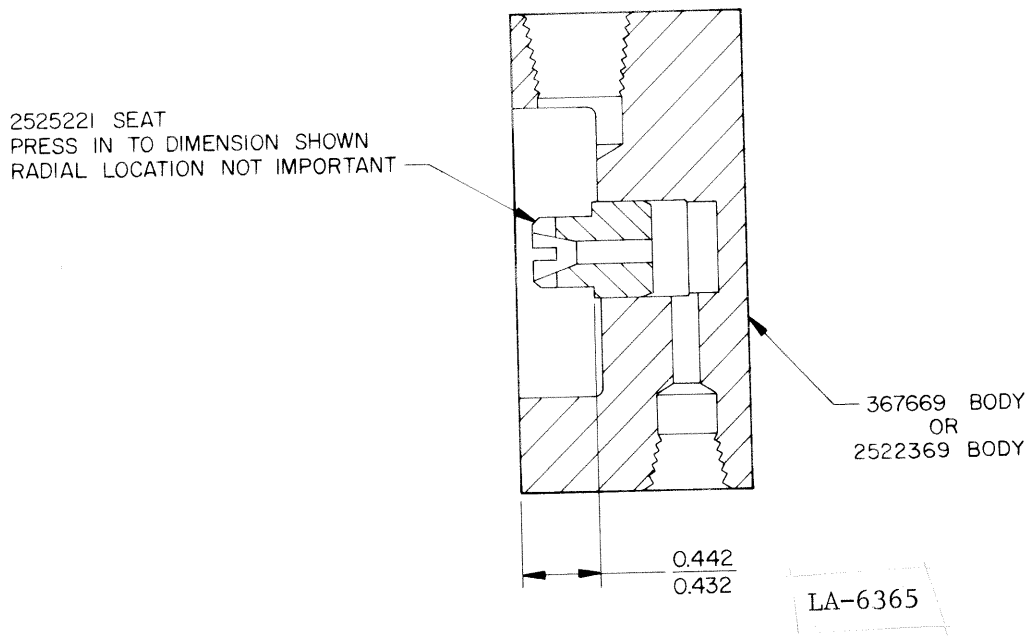

Figure 1.

3. MATERIAL INFORMATION:

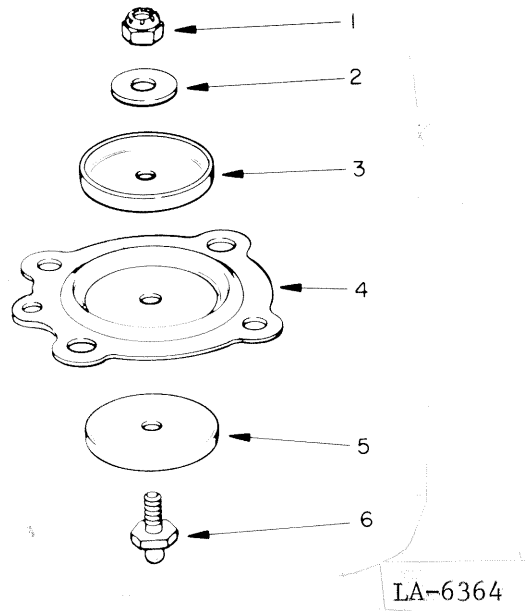

Figure 2.

<u>New P/N</u>	<u>Qty.</u>	<u>Nomenclature</u>	<u>Old P/N</u>	<u>Disposition</u>
364848	1	Nut		
364447	1	Washer		
383442	2	Cup		
2521720	1	Diaphragm	2521721 Assy.	Scrap
or				
2540888				
2525223	1	Valve		
2525221	1	Seat	367648	Scrap
	1	Valve Assy.	367632	Scrap
	1	Spring	367640	Scrap
2539344	1	Body Assy.	2522446	Rework
or			or	
2539345			367667	

K.R. Dettweiler
 K. R. Dettweiler
 Manager of Service